



Residenza “Bellavista” - Viganello

claudio lo riso architetto
www.loriso.ch - arch@loriso.ch







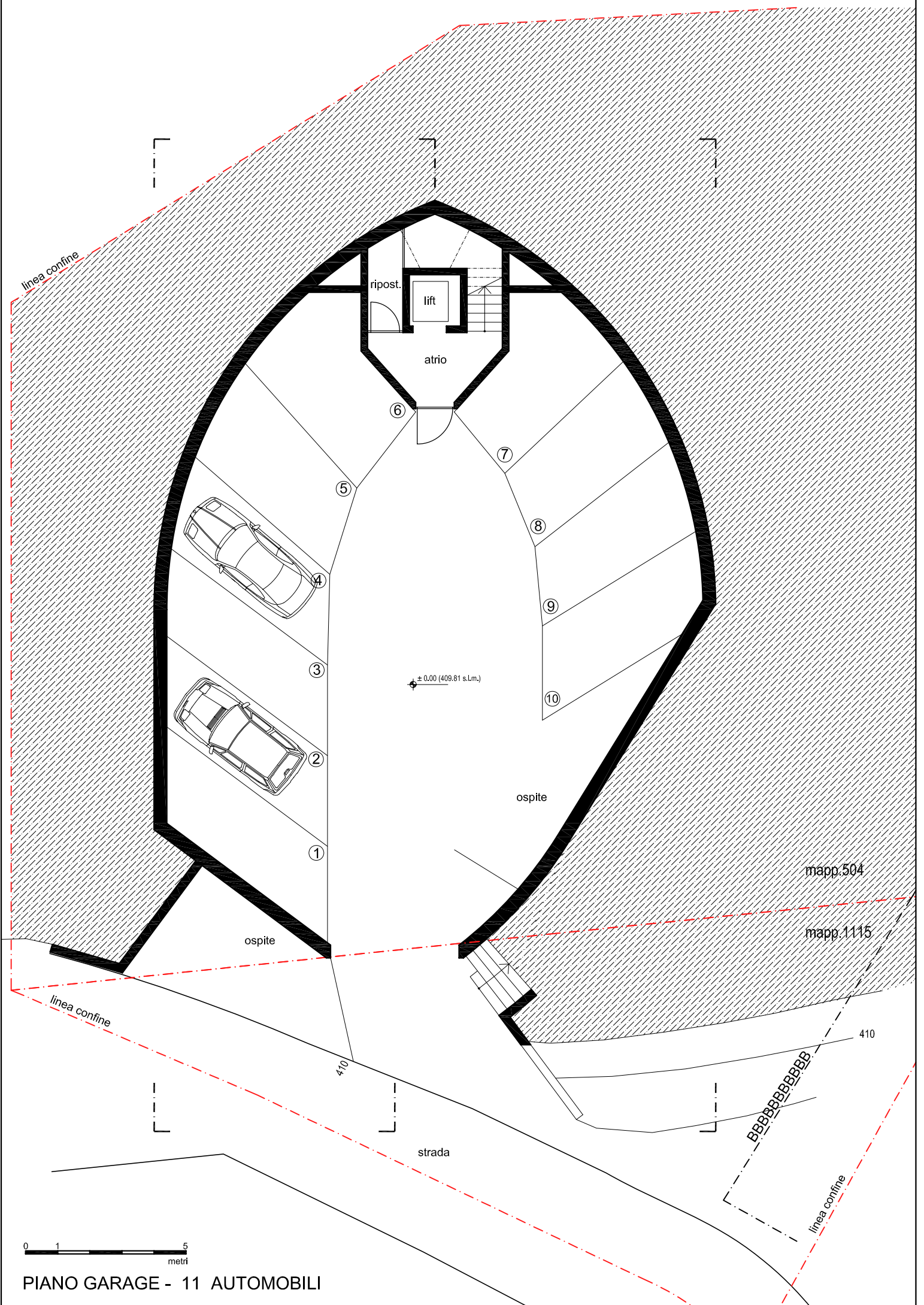

linea confine

ripost.

lift

atrio

⑥

⑦

⑤

⑧

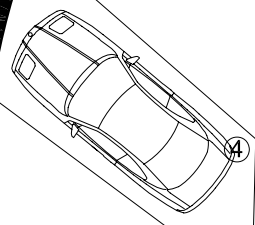

④

⑨

③

⑩

± 0.00 (409.81 s.l.m.)

②

ospite

①

ospite

mapp. 504

mapp. 1115

linea confine

410

strada

410

BBBBBBBBBB

linea confine

0 1 5 metri

PIANO GARAGE - 11 AUTOMOBILI

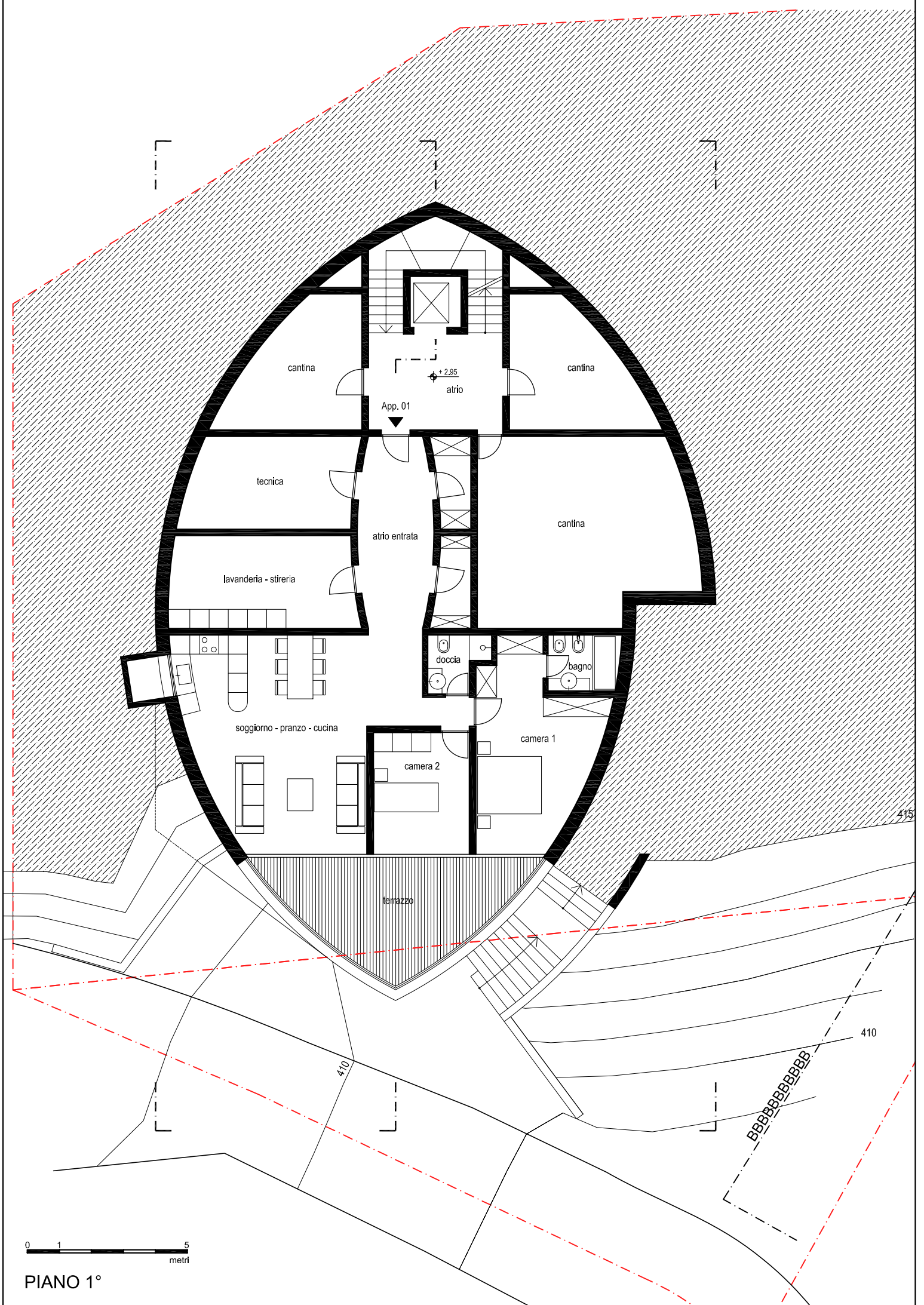

cantina

cantina

+ 2,95
atrio

App. 01

tecnica

cantina

atrio entrata

lavanderia - stireria

doccia

bagno

soggiorno - pranzo - cucina

camera 1

camera 2

terrazzo

0 1 5
metri

PIANO 1°

BBBBBBBBBB

410

410

415

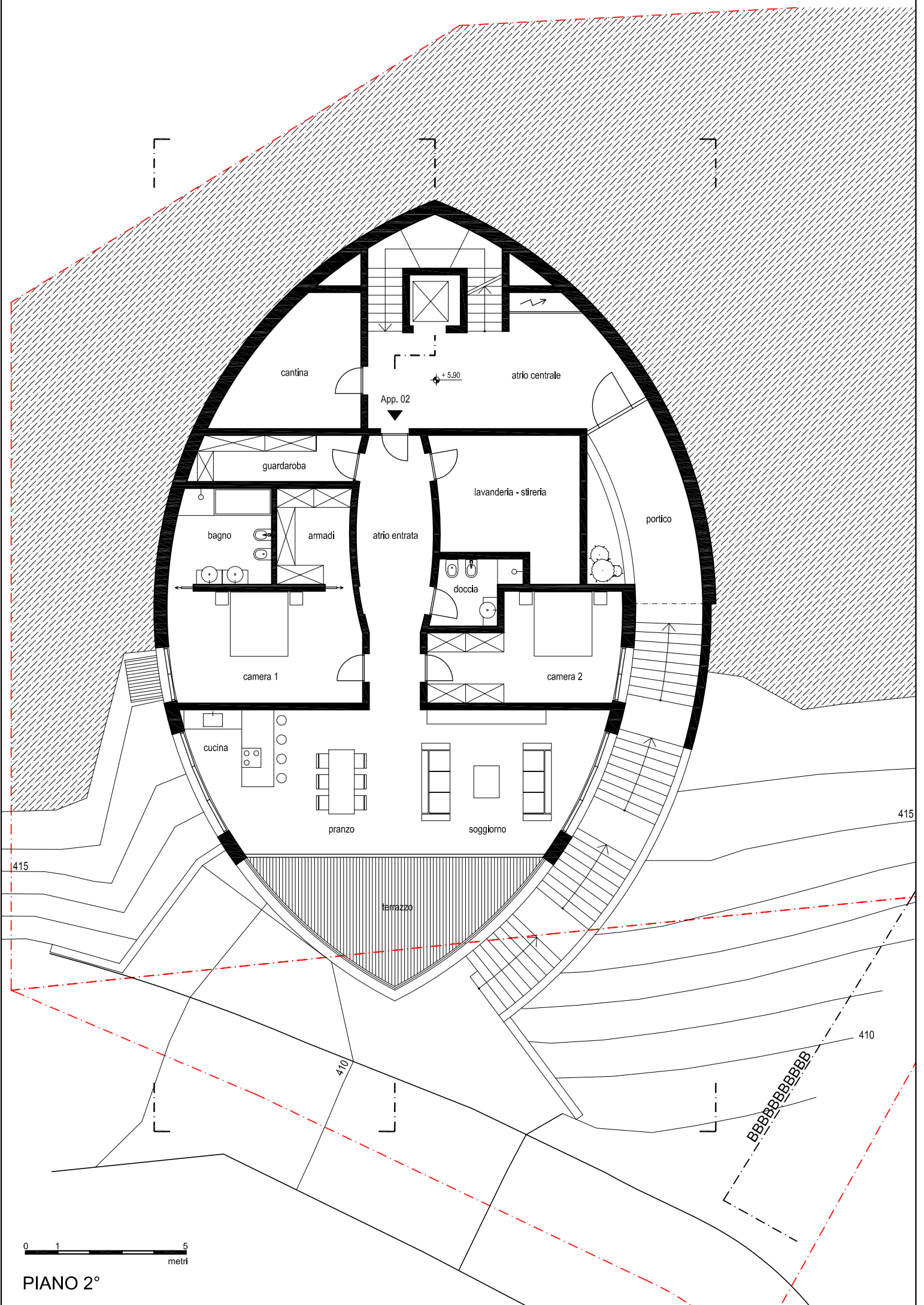

cantina

atrio centrale

App. 02

+ 5.90

guardaroba

lavanderia - stíreria

portico

bagno

armadi

atrio entrata

doccia

camera 1

camera 2

cucina

pranzo

soggiorno

terrazzo

415

415

410

410

0 1 5
metri

PIANO 2°

BB

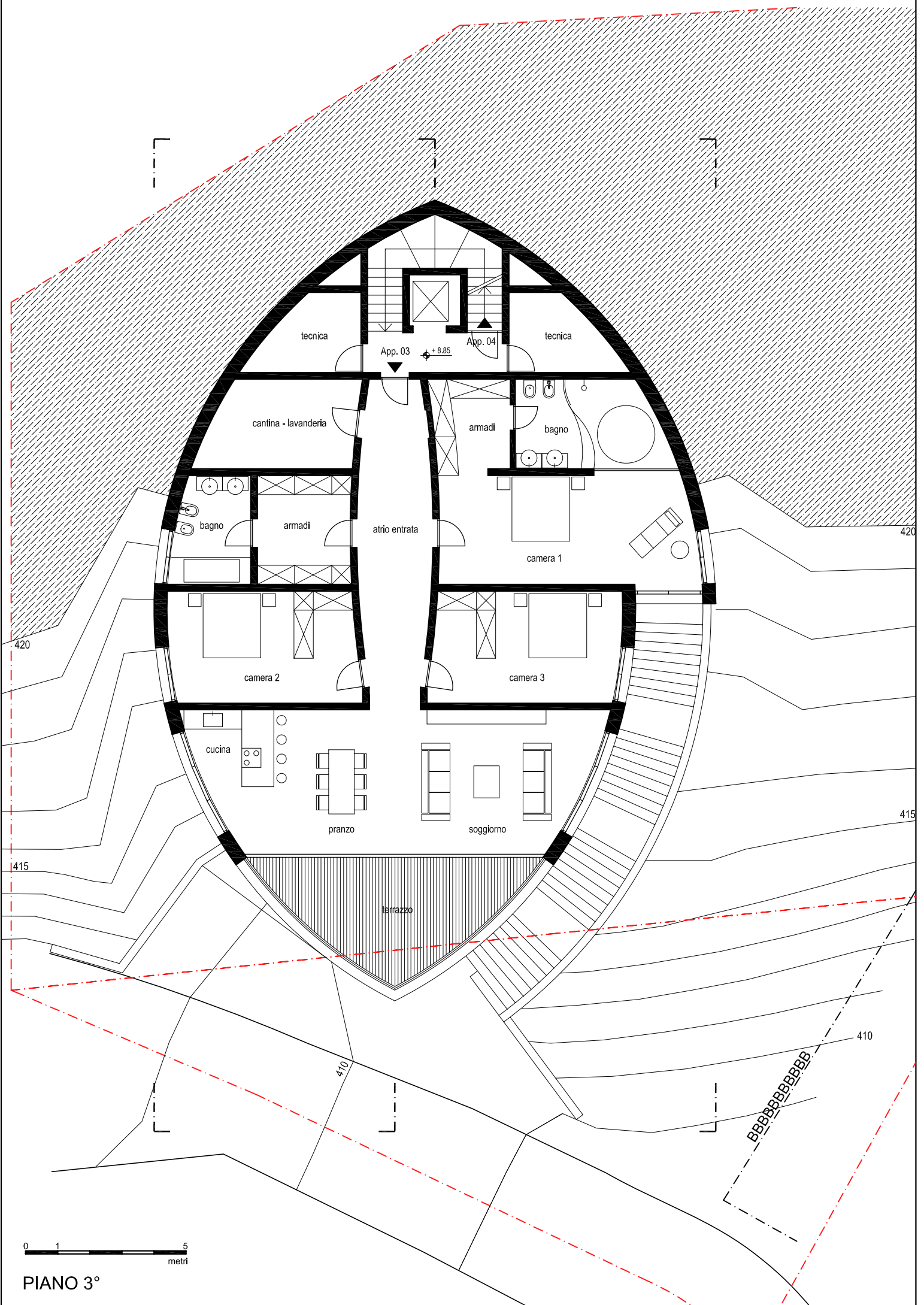

tecnic

tecnic

App. 03

+ 8.85

App. 04

cantina - lavanderia

armadi

bagno

bagno

armadi

atrio entrata

camera 1

camera 2

camera 3

cucina

pranzo

soggiorno

terrazzo

0 1 5
metri

PIANO 3°

420

420

415

415

410

410

BBBBBBBBBB

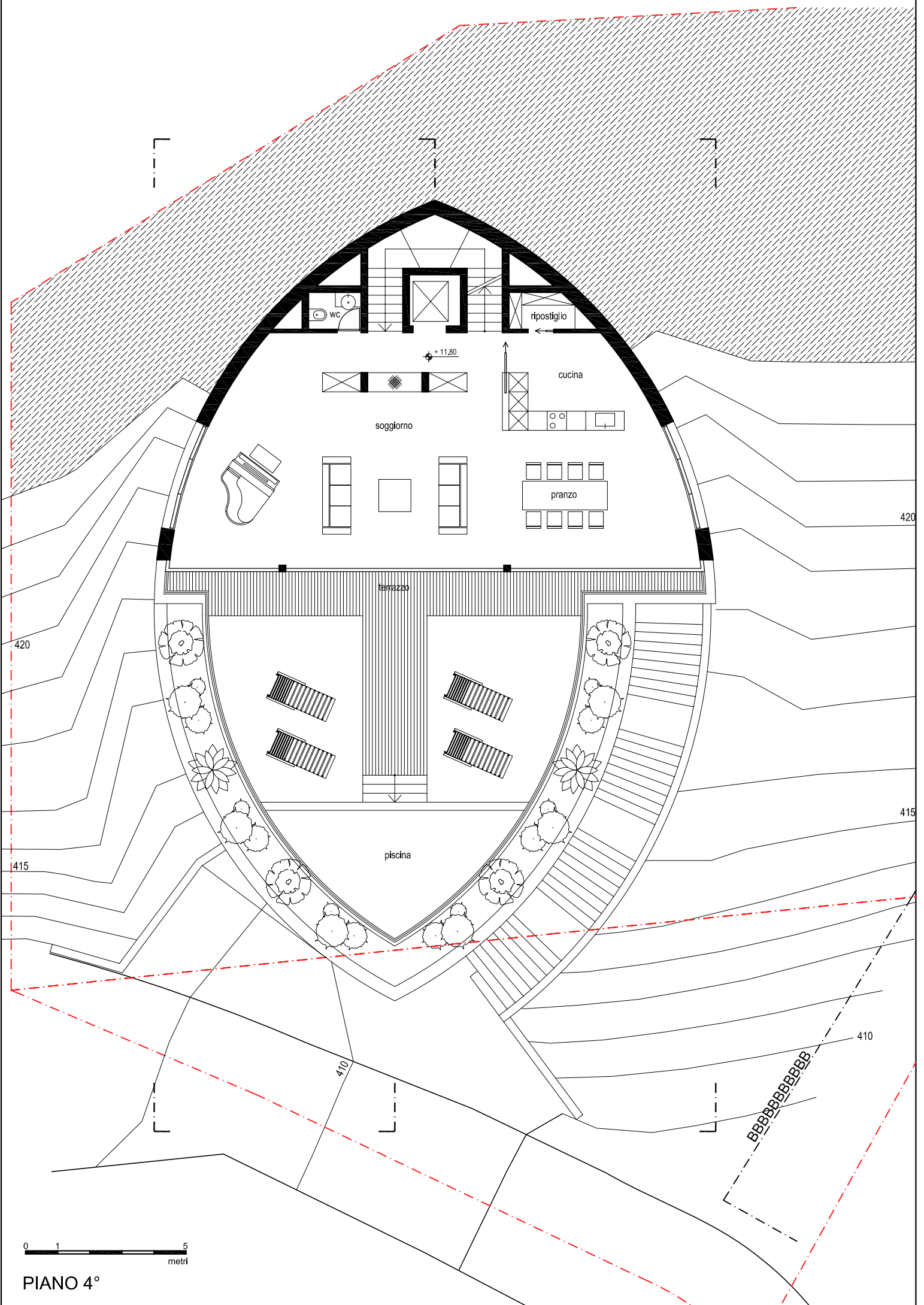

wc

ripostiglio

+ 11,80

cucina

soggiorno

pranzo

terrazzo

piscina

0 1 5
metri

PIANO 4°

BBBBBBBBBB

420

420

415

415

410

410

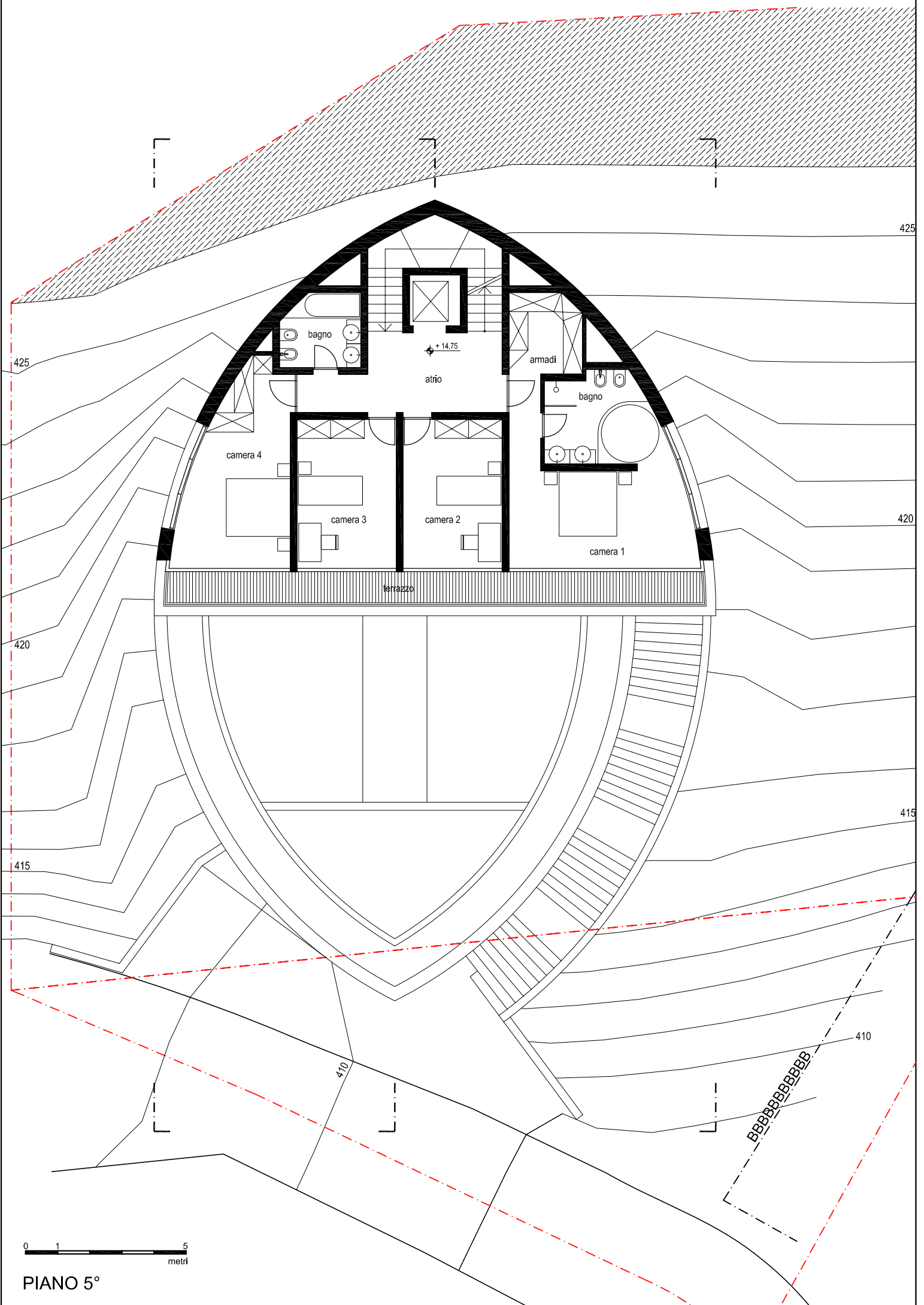

425

425

420

420

415

415

410

410

0 1 5
metri

PIANO 5°

BBBBBBBBBB

bagno

+14.75

atrio

armadi

bagno

camera 4

camera 3

camera 2

camera 1

terrazzo

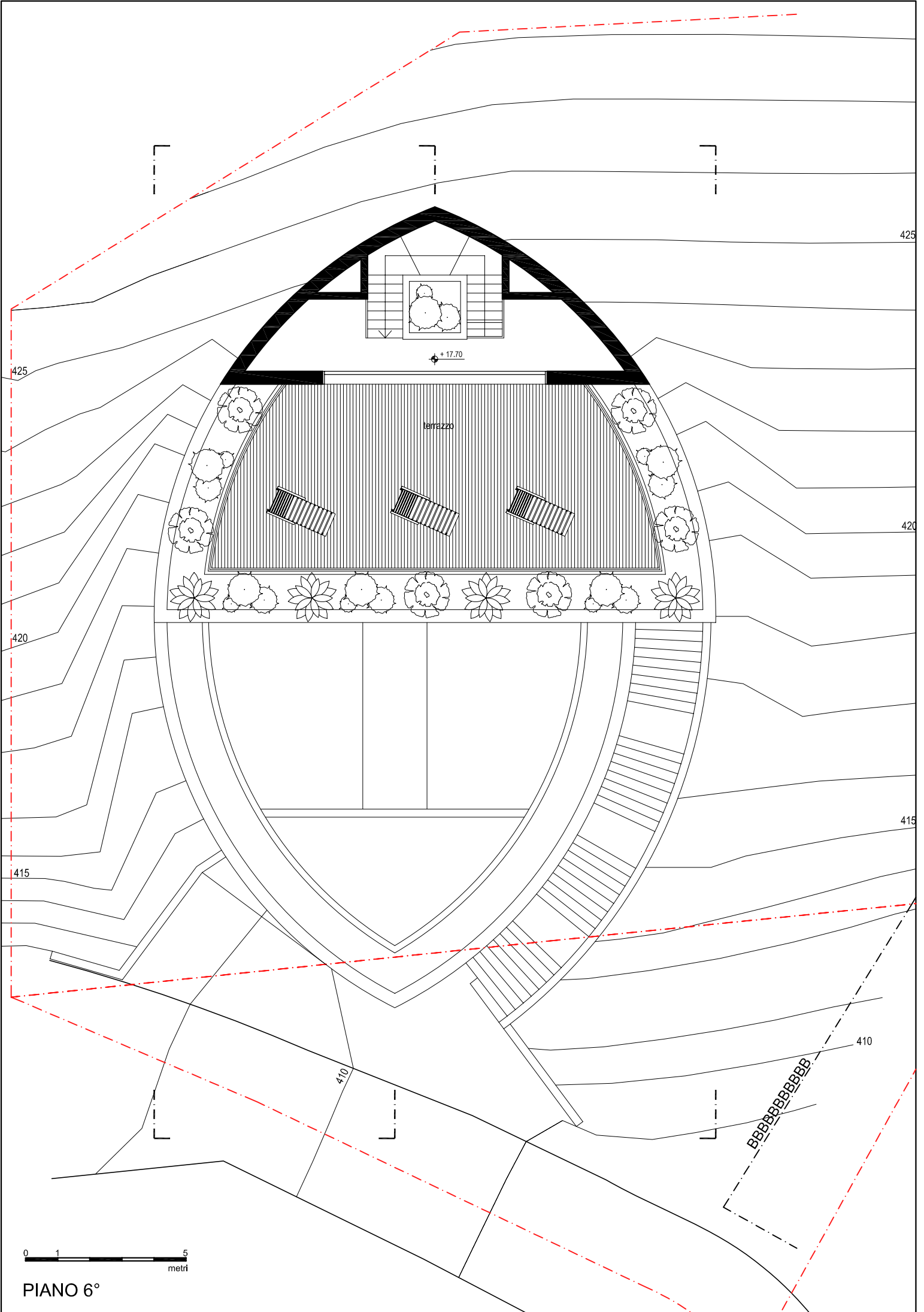

425

425

420

420

415

415

410

410

0 1 5
metri

PIANO 6°

BBBBBBBBBB

